

Ampatex® Eco 5 extra

Sustainable vapour check and airtight layer, lattice-reinforced



- > Lattice-reinforced: ideal for injection insulation
- > Soft material, easy to process
- > Easy to apply
- > ISCC-compliant: made with sustainable raw materials (62%) or PCR (Post-Consumer-Recycling)

Technical details		Value	Standard
s _d value		5 m	EN 1931
Weight		107g/m ² (±5%)	EN 1849-2
Tear resistance	longitudinal	210N/5cm	EN 12311-2/A
	transverse	160N/5cm	
Tear elongation	longitudinal	21%	EN 12311-2/A
	transverse	22%	
Resistance to further tearing (nail shaft)	longitudinal	160N	EN 12310-1
	transverse	180N	
Fire performance		E	EN 13501-1
Waterproofing at 2 kPa		passed	EN 1928
Width of overlap		10 cm	
Straightness		< 75mm/10m	EN 1848-2
Air tightness		airtight	

Area of application: Suitable for roofs, walls, floors and ceilings for constructions that are diffusion-permeable externally. Ideal for blow-in insulation thanks to high tear values.

Delivery forms			
Article number	Description	Roll dimensions	Pallet contents
7640442091308	Ampatex® Eco 5 extra	1,5 m × 50 m = 75 m ²	40 rolls = 3000m ²



*Ampack's 20-year Premium Guarantee covers material costs as well as installation and dismantling costs in the first 10 years, and material costs for a further 10 years.

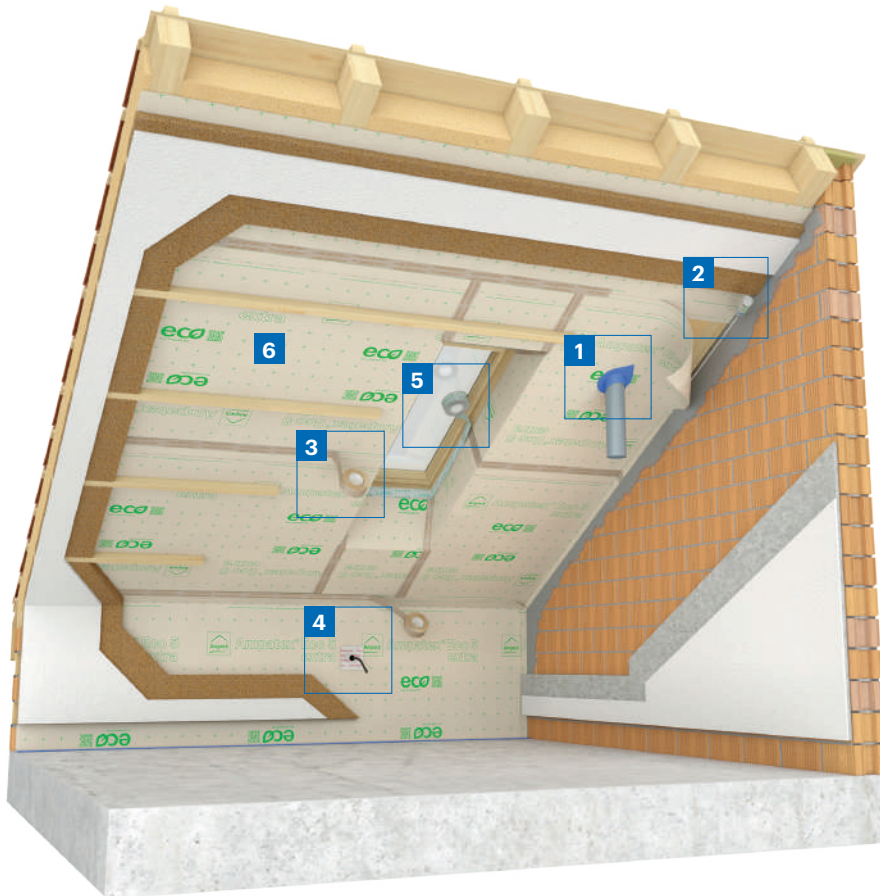

6 Ampatex® Eco 5 extra
Sustainable vapour seal and airtight layer



Tips when laying

Ampatex® Eco 5 extra is both a vapour check and an air seal. All joints, gaps, overlaps, connections and openings must be hermetically sealed. Surface damage must be sealed. In dry interiors, **Ampatex® Eco 5 extra** should be used on the warm side of the heat-insulating layer, and in areas where there is an overlap it should be fastened with concealed staples or nails. The smooth, printed side faces into the room and this is the surface onto which the next product should be taped. When laying,

make sure that the strips overlap by 10cm. The overlaps should then be completely covered with the **Ampacoll® Easy** supplied. **Ampacoll® DT** adhesive tape is useful where the underlying material cannot be nailed. Finally the lining on the inside is fixed in place. **Ampacoll® BK 530** or **Ampacoll® RA** are used for edge connections. Porous or dusty surfaces should be pretreated with **Ampacoll® Primax**. Penetrations such as ventilation pipes, conduits, purlins, rafters, etc. should be permanently sealed with

Ampacoll® BK 535 or **Ampacoll® Elektro/Install** sleeves. With porous, dusty or rough surfaces, a pretreatment of **Ampacoll® Primax** is also required.



Please observe the recommendations for use and further system products in our adhesives matrix



Further information and detailed documentation at www.ampack.biz

Sales via specialist dealers

Ampack Switzerland: +41 71 858 38 00
Ampack Austria: +43 5523 53433
Ampack Germany: +49 7621 1610264
Ampack France: +33 4 50 83 70 54
Ampack Italy: +39 471 053 475
Ampack Ireland: +353 91 394 467
www.ampack.biz



The following information may have been superseded by new findings or developments. Current Information can be found at www.ampack.biz. © Ampack AG, Rorschach, 10.2024

4137EU/EXX.YYFO(AR)1024

