



**LIGNO®**  
**Acoustic**

# Installation Instructions



Video tutorial



## Material

- **Battens for the substructure \***  
(27 mm x 60 mm), partially painted evenly on the underside to back the shadow gap e.g. with (black) emulsion paint
- **Screws** for fastening the substructure (e.g. adjusting screws Würth JAMO) and suitable dowels
- **Panels \*** LIGNO® Acoustic home – Take offcut into account when determining quantity
- **System screws 3,5x40 \*** for panel mounting (approx. 20 pcs. per m<sup>2</sup> ceiling area are required)
- **Edge batten with rebate \*** – to finish the edge of the panelling at free ends
- **Lost head nails** for fastening the edge mouldings
- Various **installation material** – depending on intended installation

## Tools

- Hammer drill
- Cordless screwdriver and suitable bit inserts
- Levelling aid (guide line, straight edge or rotation laser)
- Bit with extended tip (1 bit is supplied per pack of 3.5 x 40 screws)
- Clamps for fastening the panels when screwing
- Plunge saw
- Jigsaw with fine saw blade
- Drill, can drill if necessary

**Materials marked with \*** can be purchased in the LIGNOTREND Online Shop!

► [shop.lignotrend.com](https://shop.lignotrend.com)

# Attaching the substructure

## A1 Arrangement

- Set shadow gap width  
(Recommendation:  $w_s = 15 \text{ mm}$ )
- First distance edge slat:  
 $d_1 = 485 \text{ mm} + w_s - w/2$   
(for slat width  $w = 60 \text{ mm}$ :  $d_1 = 470 \text{ mm}$ )
- Batten distance  
 $d = 485 \text{ mm}$

## A2 Levelling plane

- Mark horizontal reference plane ①  
e.g. by means of a guide line / rotation laser

## A3 Assembly & levelling

- First install the perimeter battens ②, then fit the rest of the substructure ③
- Drill holes for suitable dowels ④, then screw in the adjusting screws over the entire surface. First, screw in completely. For levelling, unscrew the adjusting screws again until the lower edge of the slat is at a constant distance from the levelling plane ① (use a setting bar ⑥ / metre rule)

## Fittings

- If necessary, prepare pieces of battens or wooden boards ⑤ as a load-bearing substructure (e.g. for ceiling lights), measure, mount and level according to step A3. Lay cables with strain relief

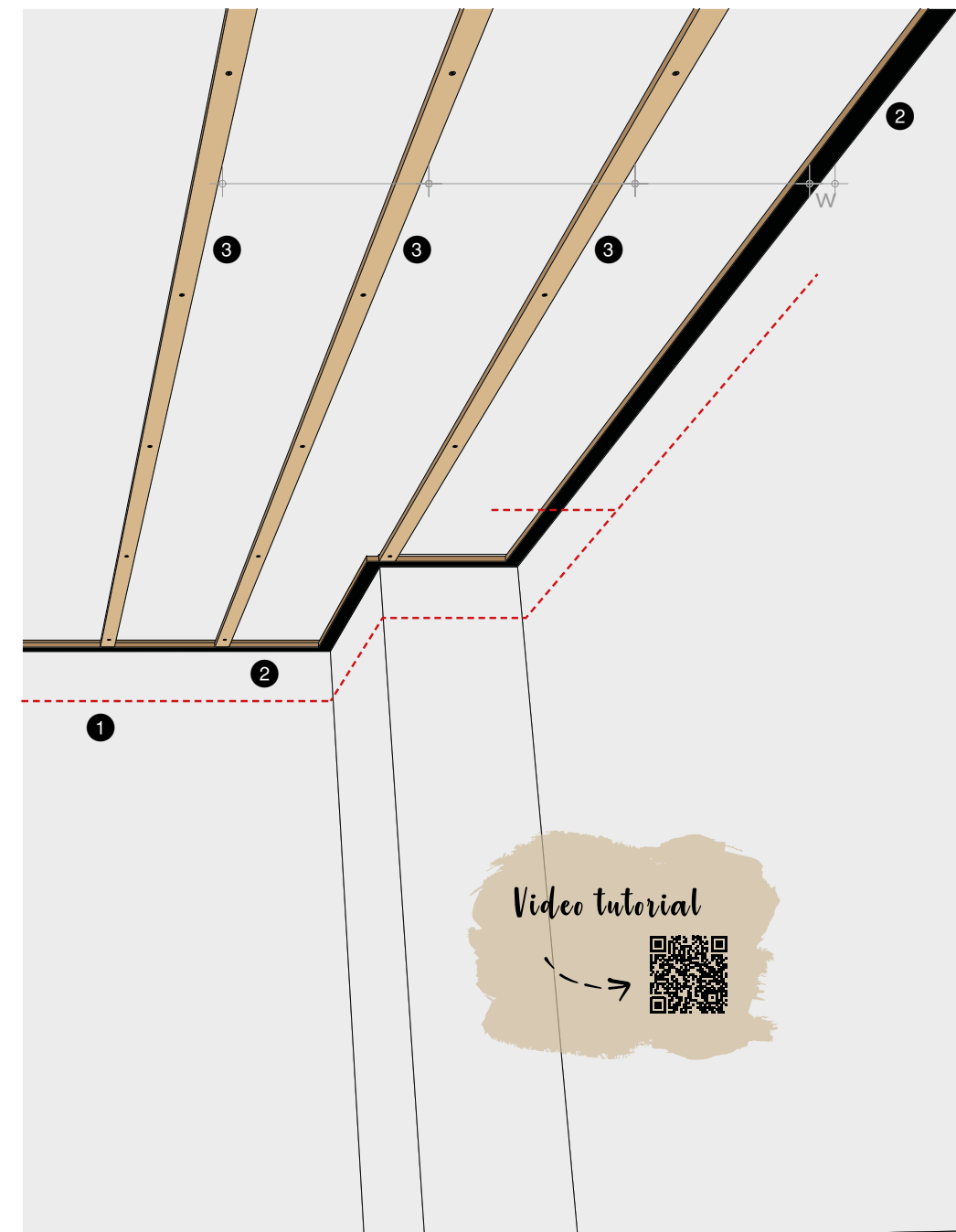
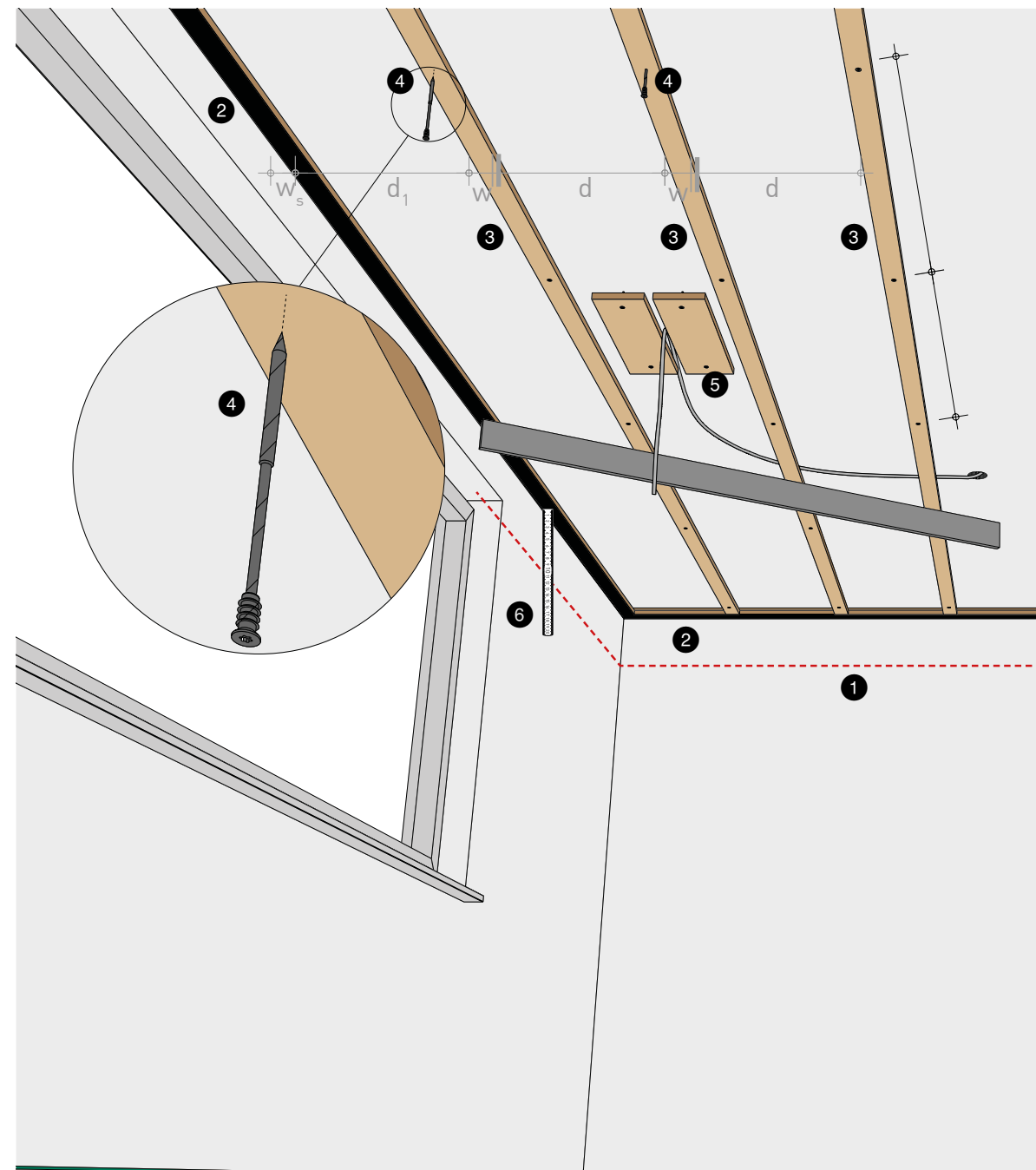
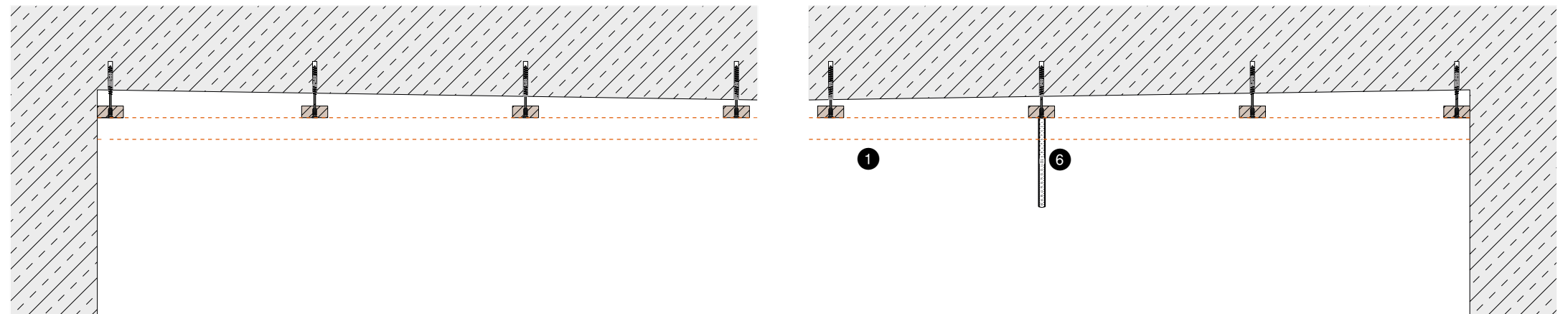

Only use anchors that are suitable for the background material.



Electrical installation may be carried out by appropriately trained specialists.

Video tutorial



# Installation as ceiling panelling

## C1 Preparation

- Attach a guideline to align the first row.
- Distance from wall:  
shadow gap width  $w_s$  plus  
panel width  $w_s + 300 \text{ mm}$   
(e.g. 315 mm with 15 mm shadow gap)

## C2 Mounting the first row

- For the first row,  
cut off the tongue of the panels
- Attach panel P1 etc.,  
ensure exact alignment
- Panel joint is always centred  
on the substructure batten ⑨,  
if necessary make a cut at the wall edge ⑧  
on the first panel
- Concealed fastening in the acoustic joints  
with 8 system screws 3.5x40 ⑦ per panel

## C3 Assembly of further rows

- Section of the last element per row (e.g. P26/2)  
can be used as the starting piece of the  
following row
- If necessary, make a cut at the first panel's  
edge ⑧ facing the wall in order to have  
the edges of the following panel joint ⑨ laying  
on the substructure again.
- Alternatively, insert the supplied flat dowel  
for fixing ⑩
- Check the alignment ✗ repeatedly



Always ensure that the tools are well sharpened. Use a saw with a guide rail for straight sections.



Wear thin gloves during installation to avoid stains



Never sand the visible side of panels that have been treated with UV protection to prevent darkening!

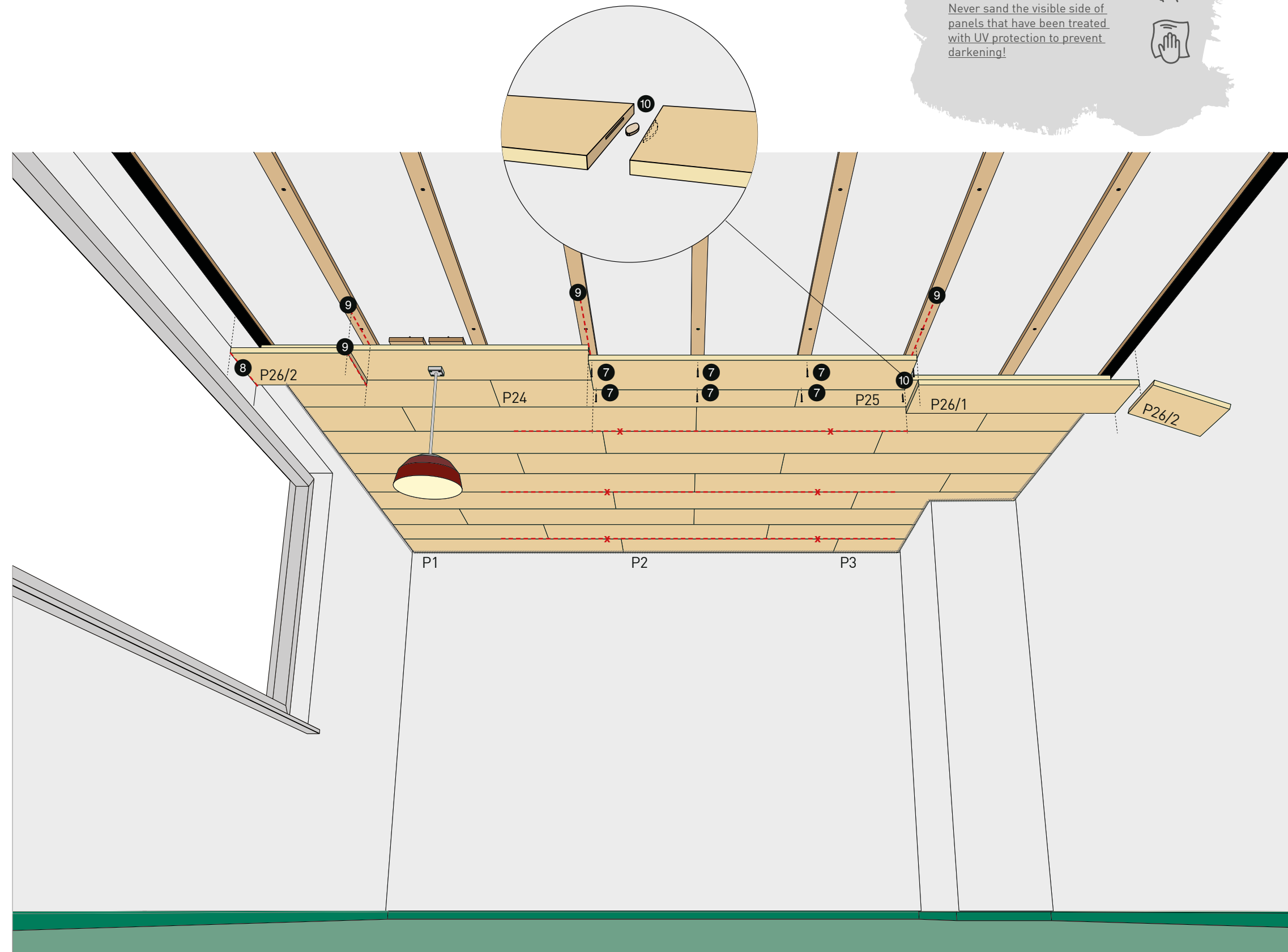

# Installation as wall panelling

## D1 Substructure

- Prepare, fasten and align the edge battens ② and substructure ③ vertically according to steps A1-A4.
- Integrate suspension points ⑤ with the required load-bearing capacity: Align flush with the front edge of the substructure, reline the gap towards the wall
- Cable installations ⑬, prepare conduits if necessary

## D2 Panel mounting

- Attach panels according to C1-C3
- Concealed fastening through acoustic gap with eight system screws Screws 3.5x40 ⑦ per panel

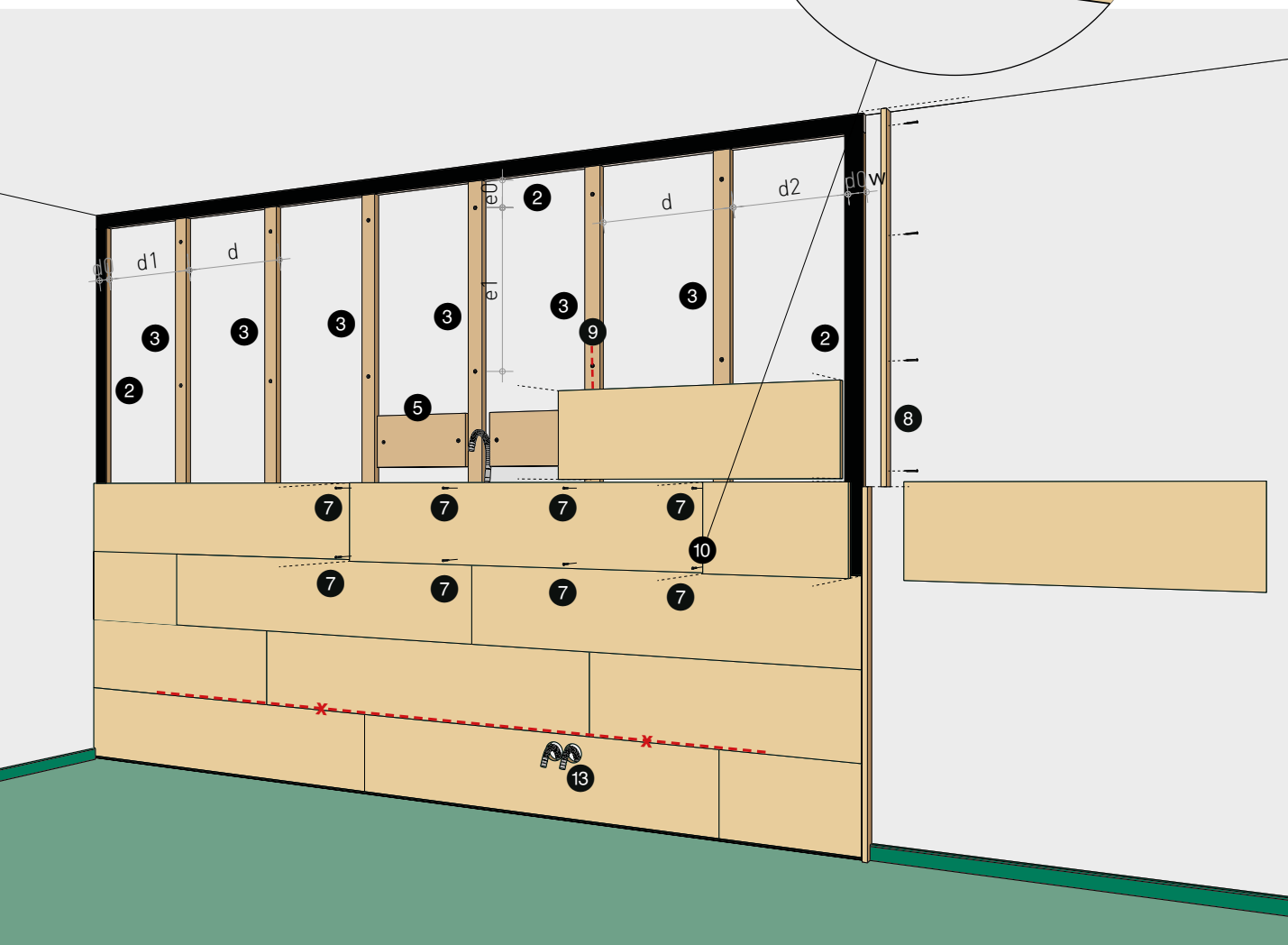
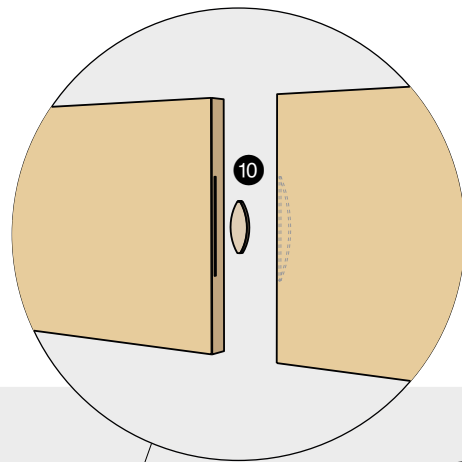

## D3 Electrical installations

- Cavity wall boxes  $\varnothing = 68$  mm, 47 mm depth for sockets etc.
- Create openings using a sharp drill bit

## D4 Edge battens

- For edging use battens with rebate ⑧. Fix with glue, a biscuit joint or lost head nail.

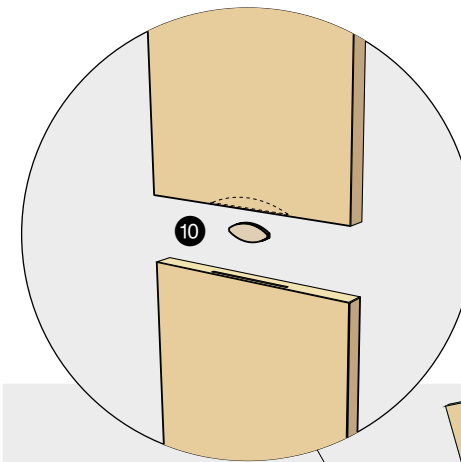

Always ensure that the tools are well sharpened. Use a saw with a guide rail for straight sections.



Wear thin gloves during installation to avoid stains



Never sand the visible side of panels that have been treated with UV protection to prevent darkening!



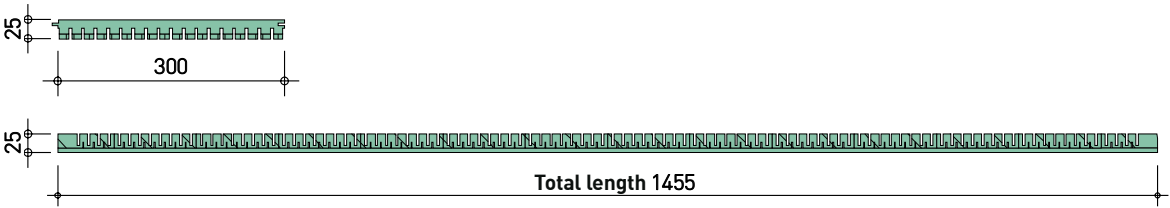

Further information / Technical data

Dimension



Surface variants

Surfaces	Treatment		Slat width	Joint width	Weight
 <div>LIGNO Acoustic home 2V_25_a100b_nfs_300-21-4_WTL_gb_buv</div>	with UV-protection	 	regular, 21 mm	approx. 4 mm	approx. 4.5 kg/Panel (10,4 kg/m²)
 <div>LIGNO Acoustic home 2V_25_a100b_nfs_300-12n25-4_WTL_gb_buv</div>	with UV-protection	 	irregular patterns, 12 -25 mm „nature“	approx. 4 mm	approx. 4.5 kg/Panel (10,4 kg/m²)
 <div>LIGNO Acoustic home 2V_25_a100b_nfs_300-21-4_WTL_gb_b0</div>	untreated		regular, 21 mm	approx. 4 mm	approx. 4.5 kg/Panel (10,4 kg/m²)
 <div>LIGNO Acoustic home 2V_25_a100b_nfs_300-12n25-4_WTL_gb_b0</div>	untreated		irregular patterns, 12 -25 mm „nature“	approx. 4 mm	approx. 4.5 kg/Panel (10,4 kg/m²)
 <div>LIGNO Acoustic home 2V_25_a100b_nfs_300-12n25-4_WTL_gb_w15</div>	Lacquered with white pigments	 	regular, 21 mm	approx. 4 mm	approx. 4.5 kg/Panel (10,4 kg/m²)
 <div>LIGNO Acoustic home 2V_25_a100b_nfs_300-12n25-4_WTL_gb_blt</div>	with UV-protection, Black lacquered joint	 	irregular patterns, 12 -25 mm „nature“	approx. 4 mm	approx. 4.5 kg/Panel (10,4 kg/m²)
 <div>LIGNO Acoustic home 2V_25_a100b_nfs_300-21-4_EI_gb_b0</div>	untreated		regular, 21 mm	approx. 4 mm	approx. 4.5 kg/Panel (10,4 kg/m²)
 <div>LIGNO Acoustic home 2V_25_a100b_nfs_300-12n25-4_EI_gb_b0</div>	untreated		irregular patterns, 12 -25 mm „nature“	approx. 4 mm	approx. 4.5 kg/Panel (10,4 kg/m²)
 <div>LIGNO Acoustic home 2V_25_a100b_nfs_300-21-4_FI-ä_gb_b0</div>	untreated		regular, 21 mm	approx. 4 mm	approx. 4.5 kg/Panel (10,4 kg/m²)
 <div>LIGNO Acoustic home 2V_25_a100b_nfs_300-12n25-4_FI-ä_gb_b0</div>	untreated		irregular patterns, 12 -25 mm „nature“	approx. 4 mm	approx. 4.5 kg/Panel (10,4 kg/m²)



Store panels in a dry place and allow them to acclimatise before installation.  
Surfaces treated with light protection glaze must not be sanded!  
Clean wooden surfaces carefully. Dry clean only.